

## New: PCCM Series Component Cleanliness Cabinet

**The PCCM Series Component Cleanliness Cabinet is the latest self-contained unit from Pall, delivering the best practices in extracting particulate contamination from a component and retaining it on a test membrane for analysis.**

Without standard, repeatable cleanliness validation, Manufacturers and Suppliers cannot meet Industrial ISO standards

- Provides a more automated, repeatable process for checking parts cleanliness
- Rapid to blank value\* to start test sampling in much less time (up to 50% quicker)
- Less human errors involved
- A fully HEPA filtered laminar air flow eliminates environmental cross contamination
- Test sample created is true representation of part contamination
- Available in standard lab friendly or larger shopfloor sized units to assess small to oversized components in accordance to ISO 18413, ISO16232 and VDA 19 procedures.

*\*relative value of cleanliness achieved over time, as specified by the customer*

### Features

- Laminar air flow with 0.3  $\mu\text{m}$  HEPA filter providing a controlled cleanliness environment (Class 5 per ISO 14644-1)
- Fast, efficient, automatic wall washing system
- Easy to use, color touch screen human-machine interface
- Full work area access for service operation
- Pressurized solvent dispensing and recycling circuits
- Able to perform system simulation tests
- Solvent vapor extracted by exhaust fan
- Requires only a power source and exhaust vent

User friendly, color touch screen control panel



PCCM Series Component Cleanliness Cabinet



Super mirror finish stainless steel extraction enclosure ( $R_a = 0.02 \mu\text{m max}$ )

## Technical information

|                          |                                                                              |
|--------------------------|------------------------------------------------------------------------------|
| Overall Dimensions:      | 1572 x 859 x 2130 mm<br>(61.9 x 33.8 x 83.9 inch)                            |
| Working area:            | 984 x 645 x 625 mm<br>(38.7 x 25.4 x 24.6 inch)                              |
| Weight:                  | 420 kg (962 lb)                                                              |
| Materials:               | Enclosure: Super mirror finish<br>304 L stainless steel<br>Frame: See option |
| Power supply:            | 110 V / 230 V – 50/60 Hz,<br>(see options) single phase                      |
| PLC:                     | Siemens                                                                      |
| Power consumption:       | 1.3 kW (without US)                                                          |
| Reservoir (solvent):     | 40 L max (10.6USg)                                                           |
| Wall flushing flow rate: | 10 L/min (2.64 USgpm)                                                        |
| Nozzle Pen flow rate:    | 5 L/min (1.32 USgpm) max                                                     |
| Rinsing pressure:        | 4.5 bar max (58 psi)                                                         |

The PCCM series cabinets comply with the European Machinery Directive 2006/42/EC, Low voltage 2014/35/EU and Electromagnetic compatibility 2014/30/EU and is fully CE compliant.

## Ordering information

Pall Cleanliness Cabinet **PCCM** 1 2 3 4

**Table 1: Voltage option**

| Code | Description              |
|------|--------------------------|
| 1    | 110V @ 50/60 Hz, 1 Phase |
| 2    | 230V @ 50/60 Hz, 1 Phase |

**Table 2: Membrane option**

| Code | Description                   |
|------|-------------------------------|
| S    | Single stage membrane holder  |
| M    | 3-Multi-stage membrane holder |

**Table 3: Ultrasonic option**

| Code  | Description                     |
|-------|---------------------------------|
| Omit  | No Ultrasonic transducer        |
| US400 | 400W Ultrasonic agitation power |

**Table 4: Door option**

| Code | Description        |
|------|--------------------|
| C    | Fixed Door (Cover) |
| S    | Sliding Door       |

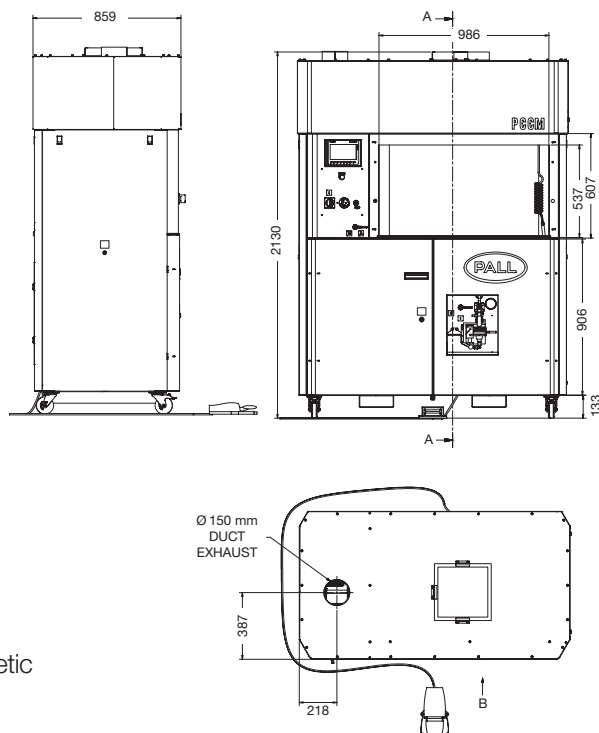

## Accessories

| Code         | Description                                                                      |
|--------------|----------------------------------------------------------------------------------|
| GHA0787OEM   | Cascade of 3 membranes                                                           |
| PCCMV2-MB    | 2 electro polished stainless steel folded bars ø14mm                             |
| PCCMV2-MBR   | 2 electro polished stainless steel folded bars ø20mm                             |
| PCCMV2MP     | Perforated plate with opening for mesh bowl                                      |
| PCCV2-USB    | Meshed bowl for u/s immersion                                                    |
| PCCMV2-MPB   | Perforated plate                                                                 |
| PCCMV2-DP    | Deflector plate                                                                  |
| PCCV2-FILLUP | Fillup kit assembly                                                              |
| PCCMV2-MG    | Electro polished stainless steel grid                                            |
| PCCMV2-MGR   | Electro polished stainless steel grid reinforced                                 |
| PCCMV2-MBMH  | Polished bowl with integrated membrane holder for PCCM                           |
| PCCMV2-MPFC  | Ducted pre-filter housing                                                        |
| PCCSV2A31    | Sliding door (available as an accessory when sliding door is not factory fitted) |

## Analysis Membranes for Component Cleanliness Assessments

- Ratings from 5 µm to 100 µm
- Materials: Polyamide

see product datasheet M&EPCCMEMENA



**Pall Corporation**

Pall Industrial Manufacturing

25 Harbor Park Drive  
Port Washington, NY 11050  
+1 516 484 3600 telephone  
+1 800 289 7255 toll free US

Portsmouth - UK  
+44 (0)23 9233 8000 telephone  
+44 (0)23 9233 8811 fax  
industrialeu@pall.com



Visit us on the Web at [www.pall.com](http://www.pall.com)

Pall Corporation has offices and plants throughout the world. For Pall representatives in your area, please go to [www.pall.com/contact](http://www.pall.com/contact)

Because of technological developments related to the products, systems, and/or services described herein, the data and procedures are subject to change without notice. Please consult your Pall representative or visit [www.pall.com](http://www.pall.com) to verify that this information remains valid.

© Copyright 2018, Pall Corporation. Pall and PALL are trademarks of Pall Corporation. ® Indicates a trademark registered in the USA. Better Lives. Better Planet and Filtration. Separation. Solution.SM are service marks of Pall Corporation.